

P11/P11P

Entry-level office IP phone

Flying Voice P11/P11P Entry-Level IP phone, with 2.4-inch color LCD with backlight, providing users with a clear visual experience. The P11/P11P supports 2 SIP accounts, integrated 100M dual network ports, PoE (P11P only) interface to meet the entry-level needs of corporate offices. It supports 6-way conferencing, HD voice, and is easy to install and wall mount, meeting different application situations of desktop office and wall mount use. This easy-to-use, cost-effective IP phone can help you improve office efficiency and achieve quality voice communication.



All-new Design, Practical details

P11/P11P adopts a new UI design, with a stylish and simple appearance and a friendly and easy-to-use operating interface, with a new breathing light caller alert, providing users with a more flexible and efficient voice collaboration experience.

HD Voice Quality, Better Calling Experience

P11/P11P uses advanced echo cancellation technology and intelligent noise cancellation technology to provide users with high-definition voice and achieve better voice calls.

Simple installation and easy deployment

P11/P11P with FRPS system and FACS platform for unified, fast and efficient bulk deployment, no need to change the existing IP network wiring, say goodbye to the complex deployment method, greatly reduce the time and labor costs, easy to manage, upgrade and maintain.

High Security, Strong Compatibility

P11/P11P are well protected by configuration files with AES, SRTP and TLS call encryption, etc. The P1X series IP phones are widely compatible with SIP based devices and PBX platforms such as Asterisk, Broadsoft and 3CX, etc.



- 2.4" 320 × 240px color display
- 2 x 10/100 Mbps Ethernet port
- 6-Way conferencing
- 2 SIP accounts
- HD Voice
- Support RJ9 headset
- Support PoE (P11P only)
- Wall mountable
- Opus

| Phone Features | |
|-----------------------------|--|
| LCD Screen | > 2.4" 320 x 240px color screen with backlight > 16 bit depth color |
| Function Keys | > 12 Function Keys:home, directory, message, paging, call Hold, Record, mute, headset, transfer, redial, hands-free speakerphone > 4 Soft Keys, 4 Navigate Keys, Volume+/- |
| SIP Accounts | > 2 SIP accounts |
| Wi-Fi | > No supported |
| USB Port | > No supported |
| Ethernet Port | > 2*10/100M (Adaptive) > Support PoE (P11P only) |
| Other Ports | > 1 x Handset port, 1 x RJ9 headset port |
| Call Features | |
| Basic function | > Call hold, mute, DND, redial, auto answer, One-touch speed dial, hotline, SMS, Call forward, call waiting, call transfer (attended/blind), Paging, Voice mail, BLF, Anonymous call, anonymous call rejection, Message waiting indicator(MWI), Hotdesk |
| Direct IP Call | > Supported |
| Phone book | > 2000 records; Phonebook search/import/export; XML/LDAP remote phonebook; Black list |
| Call history | > 60 records; Call history: dialed/received/missed |
| 6-way conferencing | > Supported |
| Audio Features | |
| HD Voice | > HD handset, HD speaker |
| Wideband Codec | > G.722, Opus, AMR-WB(Optional), G.711WB(Optional), G.711(A/u), Ilbc, G.729A/B, G.723, G.726, AMR-NB(Optional) |
| DTMF | > In-band, RFC 2833, SIP info |
| Network | |
| Network Safety | > SIP Related Features: - SIP v1 (RFC2543), v2 (RFC3261),NAT Traversal by STUN, - SIP link mode: Proxy mode and peer-to-peer SIP link mode, - Call server redundancy supported > Network Features: - Static IP and DHCP, IPv4 /IPv6, Dual stack IPv4/IPv6, ARP/RARP, DNS A/DNS SRV/DNS NAPTR, - LLDP/CDP/DHCP VLAN; IEEE802.1X; OpenVPN; DSCP, 802.1p QoS > Time and Date synchronization: STNP, PBX, DHCP > Transport Feature: UDP/TCP/TLS; RTP/RTCP/SRTP |
| Configuration & Maintenance | |
| Auto-provision | > TR069 (TR104/TR106) > FTP/TFTP/HTTP/HTTPS for Auto Provisioning > Cloud device management: FACS > Cloud device management: FRPS > DHCP Option66 |

| | |
|--|--|
| Configuration | <ul style="list-style-type: none"> > Supports Web configuration > Reset to factory, reboot > Package tracing export, system log |
| Others | |
| Physical Features | <ul style="list-style-type: none"> > New Stand, Wall mountable > AC/DC Adapter, AC Input: 100~240V, 50~60Hz > DC Output: 5V, 1A > Power consumption(PSU): 0.87~1.18W > Power consumption(PoE): 0.72~1.78W > Relative humidity: 10%~90% (No Condensing) - Storage temperature: -25~ 65°C - Operation temperature: 0~45°C > Dimension (W x D x H) : 200mm x 165mm x 47mm |
| Package Content | |
| Details | <p>Packing List:</p> <ul style="list-style-type: none"> > Flying Voice P11/P11P IP Phone, Power adapter (optional) > Handset with handset cord, Ethernet cable, Stand > Quick Start Guide <p>Size:</p> <ul style="list-style-type: none"> > Qty/CTN: 10 PCS、N.W/CTN: 7.5 kg、G.W/CTN: 9.47 kg > Giftbox size: 288mmx217mmx60mm > Carton size: 448mmx320mmx302mm |
| Certification & Compatibility | |
| Certificated by |  |
| Compatible with |  |

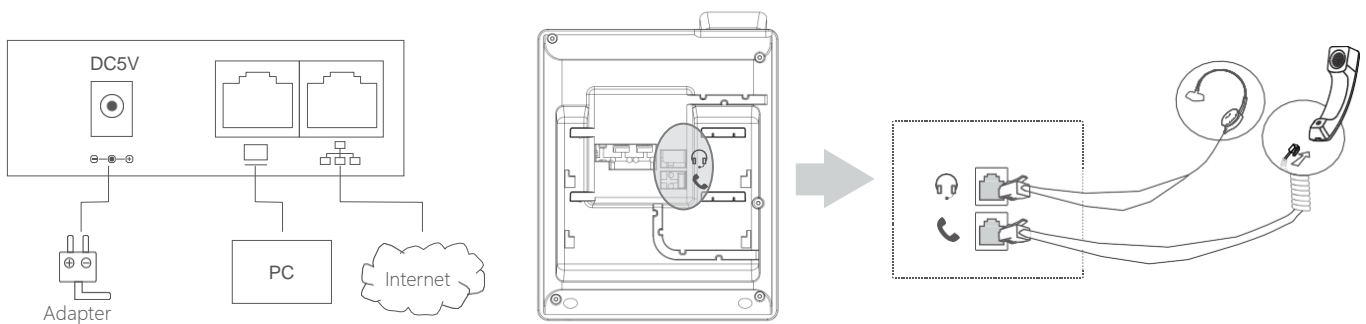

About Flyingvoice

Flyingvoice is a leading manufacturer of VoIP phones, ATA& gateways and VoIP routers. These products are preferred globally by international carriers, ITSP's, ISP's, corporate companies, and home users alike.

Driven by a need for ongoing innovation within VoWLAN technologies, Flyingvoice is committed to manufacturing products that allow for ease-of-installation scenarios within an enterprise network. Our people continuously improve existing products as well as expand upon product applications tailored to clients' requirements. These improvements ensure that your experience provides for secure, effective and efficient collaboration – anytime & anywhere.

Copyright

Copyright © Flyingvoice Network Technology Co., Ltd. All rights reserved. No parts of this publication may be reproduced or transmitted in any form or by any means, electronic or mechanical, photocopying, recording, or otherwise, for any purpose, without the express written permission of Flyingvoice Network Technology Co., Ltd.

Technical Support

Visit www.flyingvoice.com for product documents and FAQ, or contact Flyingvoice by email at support@flyingvoice.com. We'll get you the help you need.



Flyingvoice Network Technology Co., Ltd.

Website: www.flyingvoice.com

Add: 1801-1802, Building 1, Chongwen Park, Nanshan Zhiyuan,
Nanshan District, Shenzhen, China

Copyright© Flyingvoice Network Technology Co., Ltd. All Rights Reserved